

WEB SITE

Official Website (Japanese)



www.padico.co.jp

The latest product news and announcements.

Official Website (English)



<https://www.padico.co.jp/en/>

A dedicated English site with product details.

Short Videos



<https://www.padico.co.jp/movie/>

Learn how to use products through videos.
Tips and tricks are also shared - highly recommended.

SNS

X PADICO official site



Find the latest product news, announcements, updates on discontinued items, and information on workshops.

Instagram (Resin-focused)



Resin creations, design ideas, and step-by-step project recipes.

PADICO Official Instagram

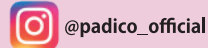

Features clay craft ideas, tutorials, and project inspiration.

PADICO Official Facebook

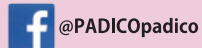

Data with new product releases, workshops, recipes, and more.

PADICO Official Line



Workshops' information, recipes, and more.

September 5, 2025 PADICO New Products



PADICO PADICO Co.,Ltd

PADICO HEAD OFFICE : 1-11-11-408 Jinguumae, Shibuya-ku, 150-0001 Tokyo Japan Tel. +81-3-6804-5171
FACTORY : 673-3 Jinba Gotemba, 412-0047, Shizuoka Japan Tel. +81-550-70-7030

New resin molds that let you create 6 kinds of plates
and 20 kinds of parts for decoration, accessories, or key charms!



First release
features these
two designs!

New molds that can be decorated with plates and parts

Create with plates and parts together, or use each piece on its own so many ways
to style and decorate! Cute designs that will make your resin work even more exciting!
Furthermore, two more types are scheduled to be released in November as the second release.

Wave

Wave-shaped plates (6 kinds) + 20 parts
including sweets-themed designs.



★ Also includes parts that can be used
as charm bases for accessories!

Speech Bubble

Speech bubble plates (6 kinds) + 20 parts
featuring weather, emotions, Christmas, and more.



※Eyes, noses, etc. shown in the samples are drawn with a pen.

Features

Brilliant Transparency

Made with Tafrect mold®, a material developed especially for resin molds, for crystal-clear results.



Plates + Cute Parts



Making accessories.

Great as a base for letter molds !



Works perfectly with Jewel Color “Cotton Candy.”



The white tint makes colors pop!

Easy to Draw On*



Draw and decorate with Copic Acrylica pens—so much fun!

*Please use pens suitable for drawing on the surface of cured resin. We have not tested all types of pens, so please check before use.



Wave Design Sample

Wave

Plenty of space for fun decorations.



Wave

Chic wave shape—perfect for bold earrings!

Earrings

Letters made with Tafrect Mold® Alphabet & Numbers.

Perfect as a birthday gift, too!

Looks adorable with lots of parts added.

Wave

Retro-Cute Flower Frame Plate



Wave

Adorable Symmetrical Wave Plate







Speech Bubble Design Sample





Wave



- 6 Wave-Shaped Plates & 20 Cute Motifs (Sweets, etc.)
- Small parts about 1 cm—easy to decorate!
- Beautiful clear finish with resin.
- Perfect for keychains and accessories.

Tafrect Mold® <Wave>
1,320 JPY without tax
#403416
JAN:4902498734169

Design registration pending

Sample Works



Letters made with Tafrect Mold® Alphabet & Numbers.

White lines and animal faces were drawn using Copic Acrylica pens.



Creations using colored resin

Speech Bubble



- 6 Speech-Bubble Shaped Plates & 20 Cute Motifs (Seasons, etc.)
- Small parts about 1 cm—easy to decorate!
- Beautiful clear finish with resin.
- Perfect for keychains and accessories.

Tafrect Mold® <Speech Bubble>
1,320 JPY without tax
#403417
JAN:4902498734176

Design registration pending

Sample Works



Letters created using Tafrect Mold® Letter Series



Creations using colored resin

Mold Size

- Diagram shown is reduced from actual size.
- Both plates and parts are 3mm thick. Base parts only are up to 2mm thick.★
- Actual size may vary slightly from the indicated ones.

Mold Details

Common to both types
Color : Translucent / Material : Thermoplastic resin
Mold size : W130mm×D4.5mm×H130mm

Gross Weight : approx. 27g (mold approx. 25g)
Upper temperature limit : 100~120°C
Cold temperature limit : - 20°C
Storage Condition : Place out of direct sunlight.

Wave

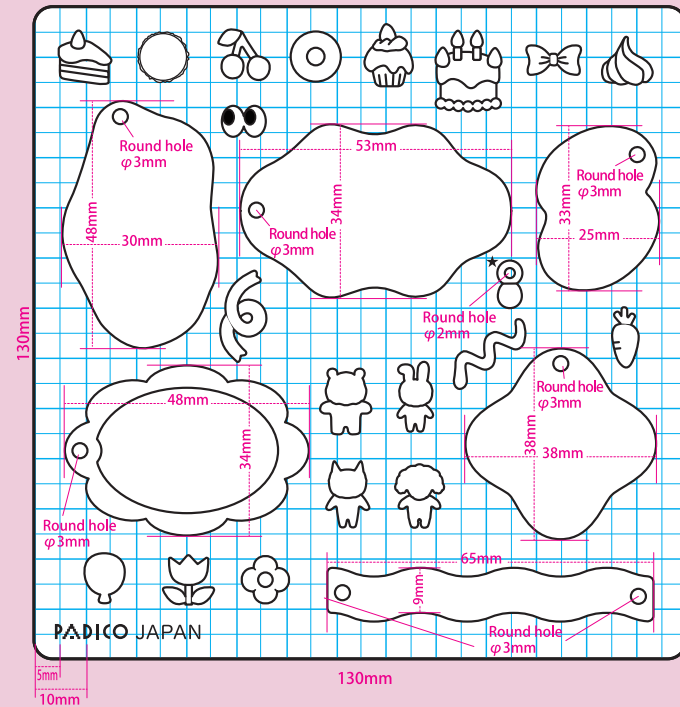

Speech Bubble

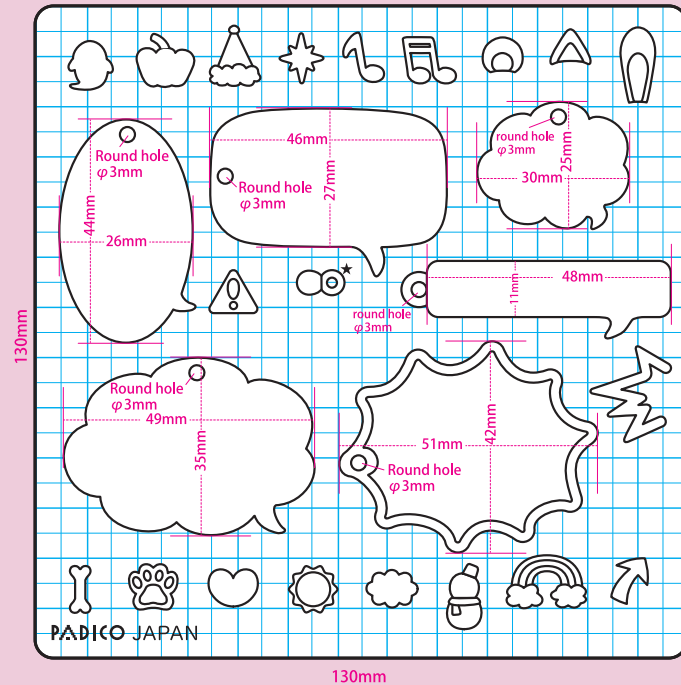

How to Use

Place a work sheet (or black paper) under the mold to see the shapes clearly.

Black Work Sheet

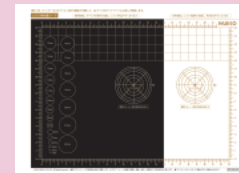

Download the black work sheet here.



Making Parts with Colored Resin

① Put UV-Resin and colorant into a mixing palette, and stir well with a stick to create colored resin.

② Put the colorant little by little with the stick.

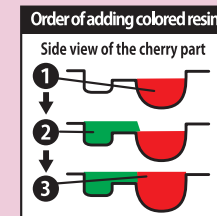

← For multi-color designs, start with the deepest part of the mold.

Cherry Example:

- ① Fill the deepest area → Cure with light.
- ② Fill the second deepest area → Cure with light.
- ③ Add resin up to the rim on the top of ① → Cure with light.

③ Finally, fill to the rim with UV-LED Resin and cure thoroughly. After cooling slightly, gently remove from the mold.

Important Notes

- Remove bubbles with a stick before curing.
- Shapes may distort slightly.
- Small works: keep out of reach of children (risk of swallowing or injury).
- For craft use only (resin, clay, etc.). Not for food.
- Keep away from direct sunlight & heat. It may deform.
- Remove works only after cooling.
- Repeated use while hot may cause cloudiness or deformation.
- Do not use in microwave or oven.
- Mold surface may have fine scratches (material characteristic).
- Do not use solvents, oils, metal spatulas, or cutters.

Extra: Drawing on Parts or Plates with Pens

- ① Fill the mold with clear resin, cure with light, let it cool slightly, and gently remove.
- ② Draw or color on the front or back surface with a pen.
- ③ Once the ink has dried, coat lightly with resin and cure again for a glossy finish.



Use Copic Acrylica

Pens You Can Use

- Pigment markers (Copic Acrylica, POSCA, etc.)
 - Resin Pens
- Some pens may not write smoothly on cured resin. Not all pens have been tested.

How to Decorate Plates

- ① Make a plate with UV-LED Resin (same as "making parts").
- ② After curing, remove plate and parts. Glue parts on the plate. Once dry, coat with resin for a glossy finish.



How to Use Base Parts★

★ The mold includes areas to make base parts.

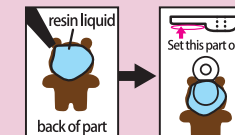

- ① Make accessory base parts with resin.
- ② Attach it to the back of parts with a little resin as shown in the drawing. Coat the entire back and cure it again.

Retro-Cute

Flower Plate Key Charm

Adorable flower plate turned into a key charm!
Cute & retro vibes with pastel Cotton Candy colors!



Materials & Tools

- ☐ "Sky Drop" UV-LED Resin
- ☐ Tafrect Mold® <Wave>
- ☐ Jewel Color for UV & UV-LED Curing Resin
(White, Strawberry Milk, Melon Sherbet)
- ☐ Mixing Stick
- ☐ Jewel Color Mixing Palette (Size-S, Mini)
- ☐ UV-LED Light
- ☐ Half Round Pearls <3mm>
- ☐ Round Jump Rings
- ☐ Keychain Fitting
- ☐ Adhesive
- ☐ Stainless Tweezers
- ☐ Flat Nose Pliers



Put Sky Drop Resin and colorant "Strawberry Milk" into a mixing palette (S size), and stir well with a stick to create redish colored resin.



In two mini mixing palettes, mix Sky Drop Resin separately with Jewel Color "White" and "Melon Sherbet".



Fill the rim of the mold with the red resin from step 1.

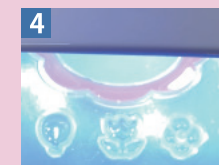

Cure under a UV-LED light for a minute.

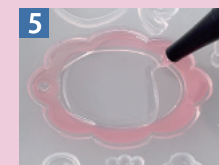

Fill the mold to the top with clear resin.



Cure for 1 minutes, then flip and cure for another 1 minute. Remove from the mold.



For the tulip motif, fill halfway with red resin. Cure 30 sec.



Fill stem and leaves halfway with green resin. Cure 30 sec.



Fill to the top with red resin. Cure 30 sec. Fill stem and leaves to the top with green resin. Cure 1 min, flip and cure another 1 min.



For the ribbon motif, fill with white resin, cure 1 min, flip, cure another 1 min. Make two pieces.



On the plate from step 6, glue the tulip and ribbons. Decorate the rim with half-round pearls.



Attach a keychain fitting with a jump ring to finish.