

New Products

Release in June, 2022



New Idea!

**Make resin plates
in any shape you like.**



How to



**Warm the line mold
with an embossing
heat gun or a hair dryer.**



**The line mold becomes softer
and more adhesive when warmed.**

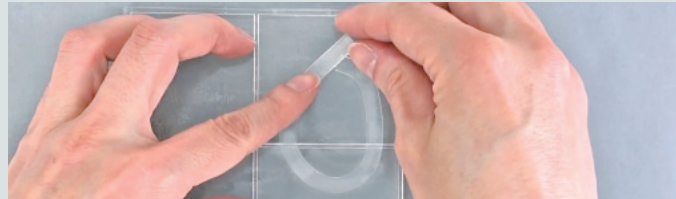

**Shape the mold into the desired
shape and attach it to a clear board.**

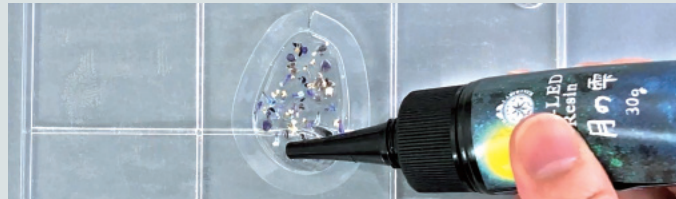

**Pour the resin into the mold
for resin jewelry.**



Charming Shapes

created by Kimura Premium



Polygonal Stones

Free to create a variety of shapes and forms



Open Oval Hanging Earrings



Cat shaped Acrylic Stand with 6mm thickness

created by Kimura Premium
twitter:@k_i_m_u_r_a / Instagram:kimurapremium_works

Release on June 24th, 2022

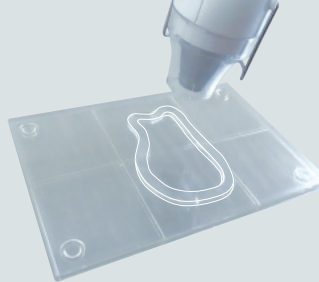

Place the heat-deformable mold named "Line Mold" on the clear board. Create the desired shape of plates with resin or clay.

Clear Board Features



1 Minimize the curvature of the resin during curing on the board.



2 UV light can be exposed from the backside.



3 Easy to check the transparency of the resin piece on the board.



4 Clay does not easily stick to the board.



Line Mold Features



1 Soften when warmed with an embossing heat gun.



2 The line mold becomes softer and more adhesive when warmed.



3 Become 3mm and 6mm thick resin molds

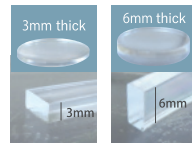

4 Make corners by cutting about half way through with scissors.

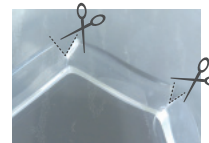

Learn more

- ✓ **Free to create** resin jewelrys with unique designs.



- ✓ **Resin plates** in 2 thicknesses

Thinner 3mm and thicker 6mm can be made by changing the position of the mold.

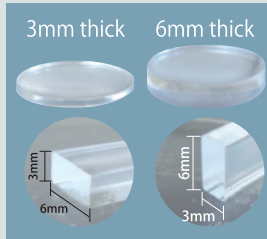

Need 6mm thickness for an acrylic stand.

- ✓ **Warm up and connect the two into one** for the large size resin piece

Warm up & connect 2 line molds for a longer one with 8cm length.



Large pieces with irregular shapes can be created.



Notes

- Line mold must be used on a clear board.
- Use an embossing heat gun or a dryer in low mode for heating line molds.
- Do not cure resin on the back of the clear board. It will not come off the board.
- Available materials
One component UV-LED Resin, 2 epoxy resins, and various clays
- If it gets dirty or the adhesion becomes weak, wipe the surface with a cleaner or wash it gently in water with a mild detergent. Dry it completely.

Clear Board with Thermoplastic Line Mold

980 JYP without tax

#403348

JAN: 4902498733483

Color: Transparent color / Packaging size: W120mm×D9mm×H185mm

Weight: 70g (Board 58g, Line Mold 2g x 2 pcs)

Storage: Out of direct sunlight

Materials: Thermosetting resin, Polycarbonate (back side of the clear board)

Made in Japan

Clear Board Size: W100mm×D6mm×H150mm

Upper-temperature limit: 80°C / Low-temperature limit: -20°C

Line Mold Size: W6mm×D3mm×H125mm

Operating temperature: 30 to 50°C



Contents

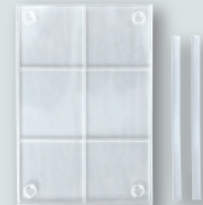

- Clear Board x 1 piece
- Line Mold x 2 pieces

Due to the manufacturing process of the clear board, there is a thin adhesive pattern on the board's lamination area, but there is no problem in use.

How to make dried flower earrings

Scan QR for online video.



3mm thick



Products & Items to be prepared

- UV-LED Resin
- UV-LED Handy Light
- Clear Board
- Thermoplastic Line Mold
- Clear Craft Tool [Round Bar & Small Spoon]
- embossing heat gun or a dryer
- dried flowers
- paper
- pen or pencil
- scissors
- tweezers
- nippers in case that the burr is removed.
- sand papers in case that the burr is removed.
- pin vise
- round jumpings
- pearl beads
- pierced earrings
- pliers



1 Draw the outline of the shape on a paper.



2 Put a line mold on board and warm it up for 10 seconds until it softens.



3 Place the clear board on the paper used in step 1.

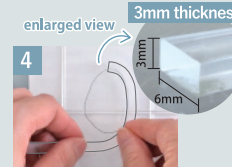

4 Shape the line mold following the drawn line.



5 If necessary, connect another line to make it longer.



6 Mark the liner mold to cut the excess.



7 Cut the excess with scissors.



8 Warm up the ends to make them stick together.



9 Pour the resin until it is two-thirds the height of the mold.



10 Put dried flowers into the resin with tweezers.



11 Using a round bar, embed flowers in resin and take resin bubbles out.



12 Cure it under UV-LED light.



13 Fill the mold full with resin.



14 Expose it both the front and back surfaces.



15 Weight it down by hand before it cools. This will prevent carving.



16 Cool down the mold and push the piece out from the mold.



17 Use a nipper to remove burrs.



18 Sand with sandpaper. If it becomes matte, coat it with resin.



19 Drill a small hole with a pin vise.



20 Set earring parts with pliers.

Release on June 24th, 2022

Store excess or colored clay tightly.
The aluminum storage pack helps reduce clay loss.



Features

Aluminum storage packs with zippers keeps clay from drying out and enable long-term storage.

→Use for any clay, e.g., stone clay, resin clay, lightweight clay, and paper clay.

※Resin clay may adhere to the film and be difficult to remove.
Wrap it before storing it in the bag.

Can make notes on the surface of the pack with an oil-based marker.

→Can also be erased by rubbing with a melamine sponge.



Cut clay as much as you need.



Put the unused clay into the aluminum pack.



Remove air and close the zipper tightly.



Type of clay, date, color, etc.
Note down with an oil-based marker.
(Can be erased with a melamine sponge.)

Resealable Aluminum Clay Bag <Set of 3 Bags>

400 JYP without tax

#403346

JAN: 4902498733469

Set of 3 bags / Color: White
Packaging size: W140mm x H255mm
Size: W120mm x H200mm
Weight: 27g (bag-5g)
Material: PET/AL/PE
Use: Storage pack of clay / Made in Japan



Contents



•Aluminum Clay Storage Bag x 3 pcs

About Storage

- Size of clay to be stored: H100 x W60 x D20mm
- Weight of clay to be packed:
 - La Doll Stone Clay 200g
 - Modena Resin Clay 150g
 - Hearty Lightweight Clay 50g
- Shelf life of clay (approx.): 3~6 months

It depends on the type of clay and the storage environment.

Once opened, there is a possibility that the clay may spoil due to bacterial adhesion.
Please use up the clay as soon as possible.



Official Site

<https://www.padico.co.jp/>



English Site

<https://www.padico.co.jp/en/>



Video showing how to use items



[Scan QR for Clear Board.](#)

SNS

follow me!



@PADICO_JP



@jewellabyrinth



@padico



@PADICOpadico



PADICO HEAD OFFICE : 1-11-11-408 Jinguumae, Shibuya-ku, 150-0001 Tokyo Japan Tel. +81-3-6804-5171
FACTORY : 673-3 Jinba Gotemba, 412-0047, Shizuoka Japan Tel. +81-550-70-7030