



NEW PRODUCTS

November

2021

Photographs, drawings, and illustrations can be transferred onto the resin surface.



Release on Friday, November 19th, 2021

patent pending



Print your favorite photo, illustration, or drawing on the transfer sheet, pour resin on the surface and cure under the UV-LED light, your original resin parts can be made easily.

Features

- Printerble transfer sheet for UV-LED resin & 2 parts epoxy resin (Patent pending)
- Print your favorite photo, illustration, or drawing on the transfer sheet,
- After curing, the surface of the resin becomes **cloudy appearance with water resistant.**
- It can be run through laser and inkjet printers.

Recommended resin



UV-LED Resin
Moon Drop



UV-LED Resin
Sun Drop

Printer driver setting

- inkjet printers (dye ink & pigment ink), color laser printers
- Print or draw the image on the rough surface of the sheet.

Printing size (100 x 148 mm)

Paper type Plain Paper
Super Fine Paper

Printing quality (Setting mode) Standard

Pens that can be used for the sheet.

- water-based pen
- oil-based pen
- ball point pen
- alcohol marker
- watercolor paint
- acrylic paint

- ✗ friction pen
- ✗ oil paint
- ✗ creyon
- ✗ pastel

- Black solid coating material may not be transferred well.
- Color may change due to the heat of curing.

Resin Printerble Transfer Sheet

480 JPY without tax

Item#: 403340

JAN: 4902498733407

- Sheet Size (W100 x H148 mm) x 5 sheets
- Inkjet printers (dye & pigment ink) / color laser printers

1 set / color: white weight: 28g

Sheet size: W100 x H148mm

Packaging size: W1220 x H 185 x D 2mm

Material: PET



Contents:

Transfer sheet x 5 sheets
(W100 x H148 mm / white color)



2 ways to use

① As a print paper, print images with a printer

Print photos and illustrations on the sheet with a home printer and transfer them to resin.



1 Prepare data of photograph or illustration. Set the transfer sheet on a printer. Print the image on a rough surface of the sheet.



2 Apply a thin layer of resin on the image. The printed surface is easily scratched, so be careful not to peel it off with a stick.

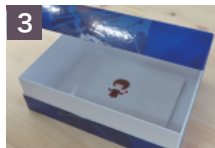

3 Leave it for about 10 minutes in a place out of the sun until the resin is penetrated to the sheet.



4 Expose it to UV-LED light to cure resin. After curing, peel the back paper off so that the transferred image appears.



5 **Whiten the back surface for clear appearance.**

Whiten the back of the resin to make the image stand out clearly.

Fix the transferred piece curls

Put the resin piece under something weighty like a book while the cured piece is a little hot.

Items suitable for white coloring

- Acrylic paint
- Marker white
- White-out

Coat the back side with resin and cure it completely.

For bubbles,

Take time to remove bubbles with a stick or a pin.

② Transfer your hand drawings

Draw illustrations direct on the transfer sheet with pens and transfer them to resin.



1 Draw illustrations direct on a rough surface of the transfer sheet with pens and dry the ink well.

※ See "Pens that can be used for the sheet"



2 Apply a thin layer of resin on the illustration and leave it for 10 minutes.

For bubbles,

Take time to remove bubbles with a stick or a pin.

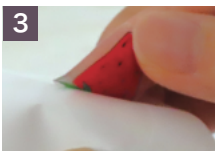

3 Expose it to UV-LED light to cure resin. After curing, peel the back paper off so that the transferred illustration appears.



Fix the transferred piece curls

Put the resin piece under something weighty like a book while the cured piece is a little hot.



5 Coat the back side with resin and cure it completely.

Put accessory parts on.

Make a small hole with a pin vise to set jump rings.

※ Depending on the ink, discoloration may occur due to aging.

Clay does not stick to the sheet,
and it is easy to clean.



Release on Friday, November 19th, 2021

Non-stick silicone gives comfortable
to use when making clay pieces and
when removing resin pieces after curing.



Features

- Clay does not stick to the sheet, even if stretching clay thinly on it.
- It is easy to make mirror finish with the flat silicone sheet.
- It can be used as a craft board by putting it on the cardboard.

as a work board,



It is suitable for clay flower making and resin craft.

To have a flat surface,



Put the silicone surface down on the mold that is filled with resin to have the resin surface flat.

How to set a silicone work board.

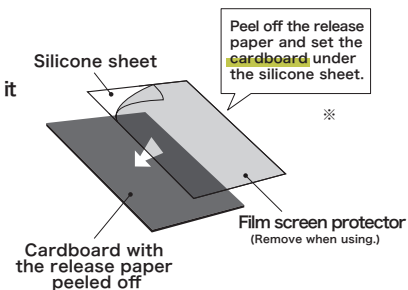

※ Make sure the PET rough side down and the silicone side up and attach it to the board.

● If the silicone film deteriorates and comes off, replace it with a new sheet.

Silicone sheet

-Glued cardboard -

480 JPY without tax

Item#: 403339

JAN: 4902498733391

Silicone sheet x 2, Paper board x 1

Set: 1/ Color: Transparent, White

Weight: 48g

Sheet size: A6 size (W105 x H148mm)

Packaging size: W120 x H185 x D4mm

Materials: PET sheet, Cardboard



Contents

- Silicone sheet (transparent) x 2 pcs
- Cardboard (white) x 1 pc



[Silicone sheet]



[Cardboard]

Suitable work space for resin transferring

Use this silicone sheet
to minimize the curvature of resin.

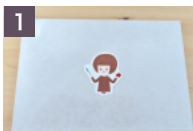

Place a printd transfer sheet to the silicone one.

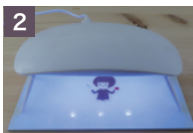

Apply a thin layer of resin to the designed surface and cure it under the UV-LED lamp.



Turn the surface over and press it against the silicone sheet to stretch it in case of curving.



Peel a release paper off and apply resin to the back side as well.

Easy to clean

Gently wipe the silicone surface with a wet sheet or resin cleaner.
After that, attach a screen protector film on it.

Release on November 19th, 2021



Sand the clay surface with sandpaper.
Perfect size for use in making resin accessories.

Features

- Mini size sandpapers so you can use it without cutting.
- Use for chamfering, deburring, and polishing.
- It can also be water-polished to prevent dust from scattering during polishing.



Resin Polishing



Dust does not scatter when sanded resin with water.

#240	Very fine
#400	Extra fine
#1,000	Super fine

Sandpaper Waterproof Paper Set

Mini size wet/dry sandpapers
Grit Size #240, #400, #1000 /3 pcs each

JPY 200 without tax

Item#: 403342
JAN: 4902498733421

Set: 1/Weight: 8 g
Paper Size: W32.5×H70mm
Packaging size: W80×H140×D3mm



Contents

Sandpaper
3 pcs per grit size

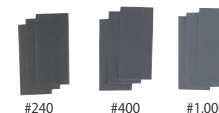



Enjoy Clay Flower Making.

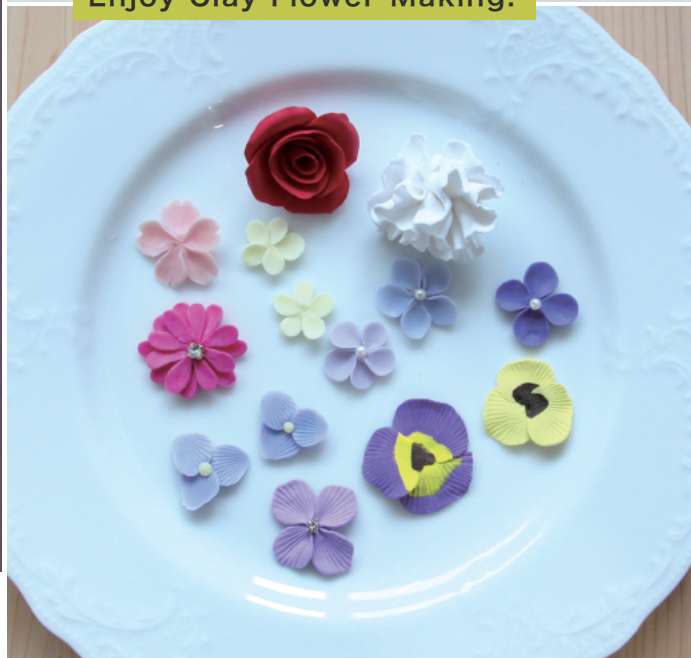

Release on November 19th, 2021.

patent pending

Application for utility model registration



Dual-ended design,
comfortable tools with excellent
surface releasability that do not
easily stick to clay or resin.
Ideal for clay flower craft.

Features

- Useful tool that does not stick to clay.
- It can used as a clay petal former.
- Transparent tool makes it easy to model the shape of clay.
- Good for stirring, scooping, removing bubbles, and spreading resin out



Transparent resin tool
with excellent surface
releasability. Resin dye
does not transfer to
the tool.



The clear tool makes it
easier to check the
shape of clay and to
form clay petals with.



Versatile modeling tool is
perfect for resin making,
to stir, scoop, remove
bubbles, and coat.

Easy to clean

After use, wipe it out gently with
wet tissue and dry it out.

Please note that air bubbles were formed
on the handle of the tool during the
process of the production, but there is
no problem with the strength of the tool.

Small Spoon



[front] [side]

Various ways to use

Make clay petals



Put clay on and smooth the surface



Push up clay



Spread resin out



Various ways to use

Make holes



Spread clay



Draw lines



Do resin craft



Large Spoon



[front] [side]

Various ways to use

Make clay petals



Spread clay



Put clay on and smooth the surface



Make color clay



Various ways to use

Smooth clay surface



Add clay on



Work on details



Mix resin colors



Large Spoon with line texture



[front] [side]

Various ways to use

Make clay petals with flower veins



Put striped pattern



Spread clay to make it thinner



Various ways to use

Cut clay



Draw lines



Make holes



Use for resin work



Round Bar

Clear Craft Tool

<Round Bar & Small Spoon>

520 JPY without tax

Item#: 403336

JAN: 4902498733360

1 pc

Color: Translucent / Packing weight: 9.4 g (Rod: 5g)

Tool size: W9×H160mm

Packaging size: W60×H230×D9mm

Material: Thermoplastic resin

Upper temperature limit: 80°C

Cold temperature limit: -20°C



Clear Craft Tool

<Spatula & Large Spoon>

520 JPY without tax

Item#: 403337

JAN: 4902498733377

1 pc

Color: Translucent / Packing weight: 9.9g (Rod: 5.5g)

Tool size: W20×H160mm

Packaging size: W60×H230×D9mm

Material: Thermoplastic resin

Upper temperature limit: 80°C

Cold temperature limit: -20°C



Clear Craft Tool

<Cutter & Large Spoon with line texture>

520 JPY without tax

Item#: 403338

JAN: 4902498733384

1 pc

Color: Translucent / Packing weight: 9.9g (Rod: 5.5g)

Tool size: W20×H160mm

Packaging size: W60×H230×D9mm

Material: Thermoplastic resin

Upper temperature limit: 80°C

Cold temperature limit: -20°C





Hydrangea flowers

with the dual ended tool
"cutter & striped pattern spoon"

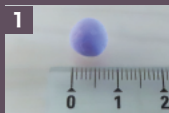

1 Make a 7mm clay ball for a petal with the color you like.

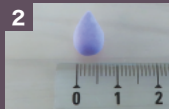

2 Form it to a drop as shown in the photo.



3 Press it slowly with the spoon.



4 Pinch the tip a little.



5 Shape with scissors as shown in the photo. Make four petals.



6 Make a 5mm clay ball with the same color, push a little to make a round base.



7 Glue to the tip of the back of the petal.



8 Set 4 petals on the base.



9 Press the center of the flower gently so that 4 petals face inward.



10 Put a pearl or a stone in the center with glue. Let the flower dry.



Rose flower

with the dual ended tool
"spatula & large spoon"



1 Make a 1cm clay ball for one petal with the color you like.



2 Form it to a drop as shown in the photo.



3 Put it in your palm and press it gently with the spoon.



4 Pressing and sliding the clay to thin the edge of the petal.



5 Make 10 petals shaped like the picture.

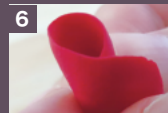

6 Roll the first petal as shown and this will be the center of the rose.



7 Attach petals around the rose one by one. Press the bottom with fingers to stick to the others.



8 Last 3-4 petals be warped a little outward with your fingers.



9 Cut away extra clay at the bottom, smooth the bottom by fingers, and let the rose dry.

PADICO

PADICO HEAD OFFICE : 1-11-11-408 Jinguumae, Shibuya-ku, 150-0001 Tokyo Japan Tel. +81-3-6804-5171
FACTORY : 673-3 Jinba Gotemba, 412-0047, Shizuoka Japan Tel. +81-550-70-7030



@PADICO_JP

@jewellabyrinth



@padico



@PADICOpadico

www.padico.co.jp/en/